

Fontainebleau Junior High Procedures

ARRIVAL

- Car line begins at 8:15 a.m.
- Breakfast will be offered as a “Grab and Go” with locations on both sides of campus.
- Students in car line exit their vehicles and enter campus by the Gym (on the right side of the office). Car riders get their breakfast from the Gym side of campus.
- Students on buses exit the bus and enter campus by the Cafeteria (on the left side of the office). Bus riders get their breakfast from the Cafeteria.
- Upon arrival, students must report directly to their first period of the day.
- Students will eat breakfast in their first period class.

CLASS EXCHANGE

- Classes will dismiss by grade levels at staggered times to get to and from their next class.

LUNCH

- We will have three lunch periods this year.
- Students may eat lunch in the Cafeteria, at the picnic tables, or on the benches. Social distancing must be maintained in all lunch areas.

DISMISSAL

- Groups of buses will be dismissed. (Some will load in the front and some will load in the back)
- Walkers will be released.
- Car line will begin *after* buses in the front of school begin leaving.

CAR LINE PROCEDURES

- There will be two lines: one for 8th grade and the other for 7th grade. Please see the map on the second page.
- All car line parents will receive a printed copy of a QR code. ([What is a QR code? Click here.](#)) This QR code will not change and can be reused each day. Please hold on to your copy of the code.
- Scan the code with your phone (depending on your phone you might need to download a free QR scanner app) once you are on campus and stopped in car line. Please do not use the QR code before you get to campus, as this may cause crowding issues.
- Once the QR code is scanned, you will be directed to a form where you will enter your child's name. This will alert teachers to dismiss them from class.

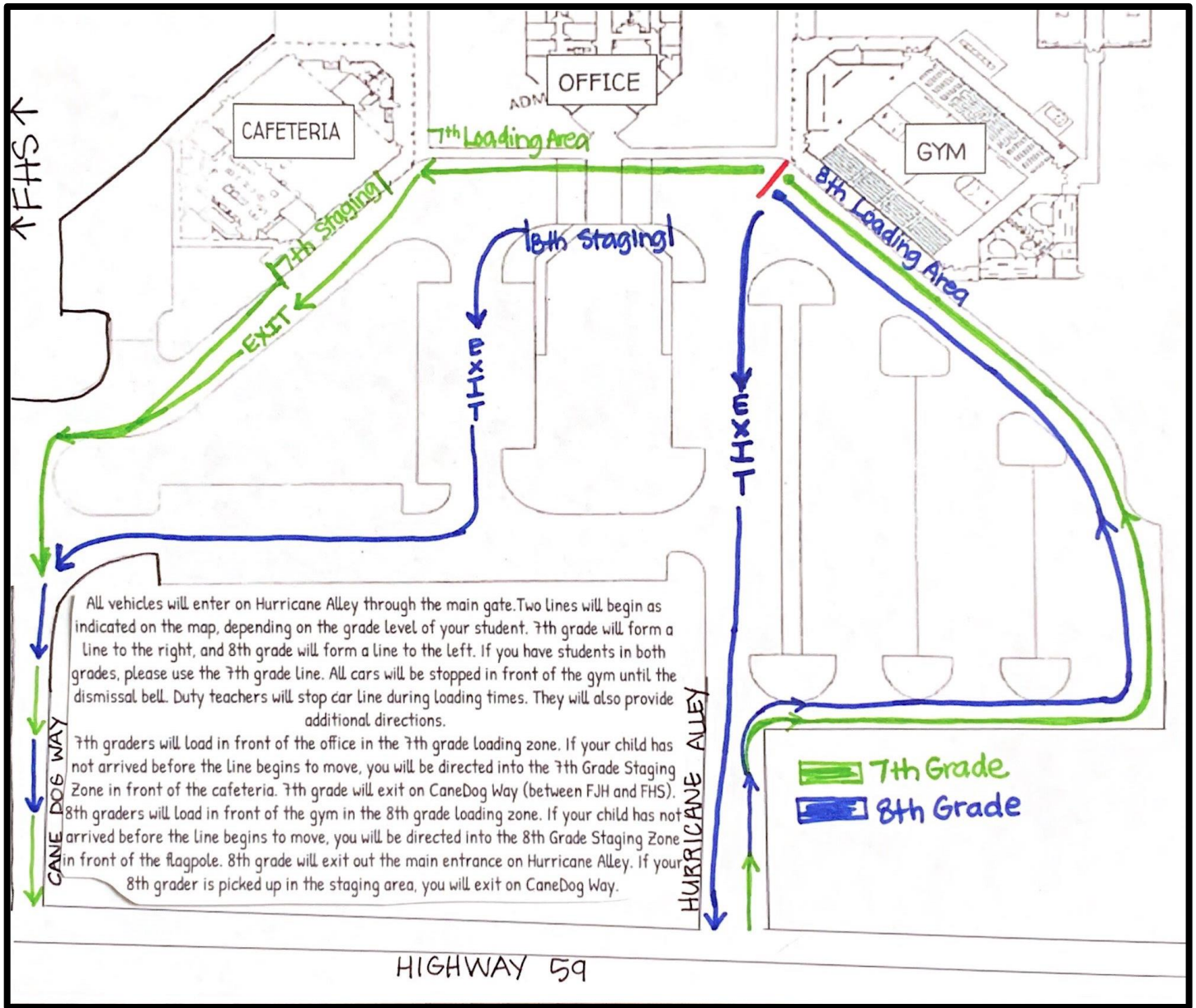

All vehicles will enter on Hurricane Alley through the main gate. Two lines will begin as indicated on the map, depending on the grade level of your student. 7th grade will form a line to the right, and 8th grade will form a line to the left. If you have students in both grades, please use the 7th grade line. All cars will be stopped in front of the gym until the dismissal bell. Duty teachers will stop car line during loading times. They will also provide additional directions.

7th graders will load in front of the office in the 7th grade loading zone. If your child has not arrived before the line begins to move, you will be directed into the 7th Grade Staging Zone in front of the cafeteria. 7th grade will exit on CaneDog Way (between FJH and FHS).

8th graders will load in front of the gym in the 8th grade loading zone. If your child has not arrived before the line begins to move, you will be directed into the 8th Grade Staging Zone in front of the flagpole. 8th grade will exit out the main entrance on Hurricane Alley. If your 8th grader is picked up in the staging area, you will exit on CaneDog Way.

HIGHWAY 59

↓ FHS ↓

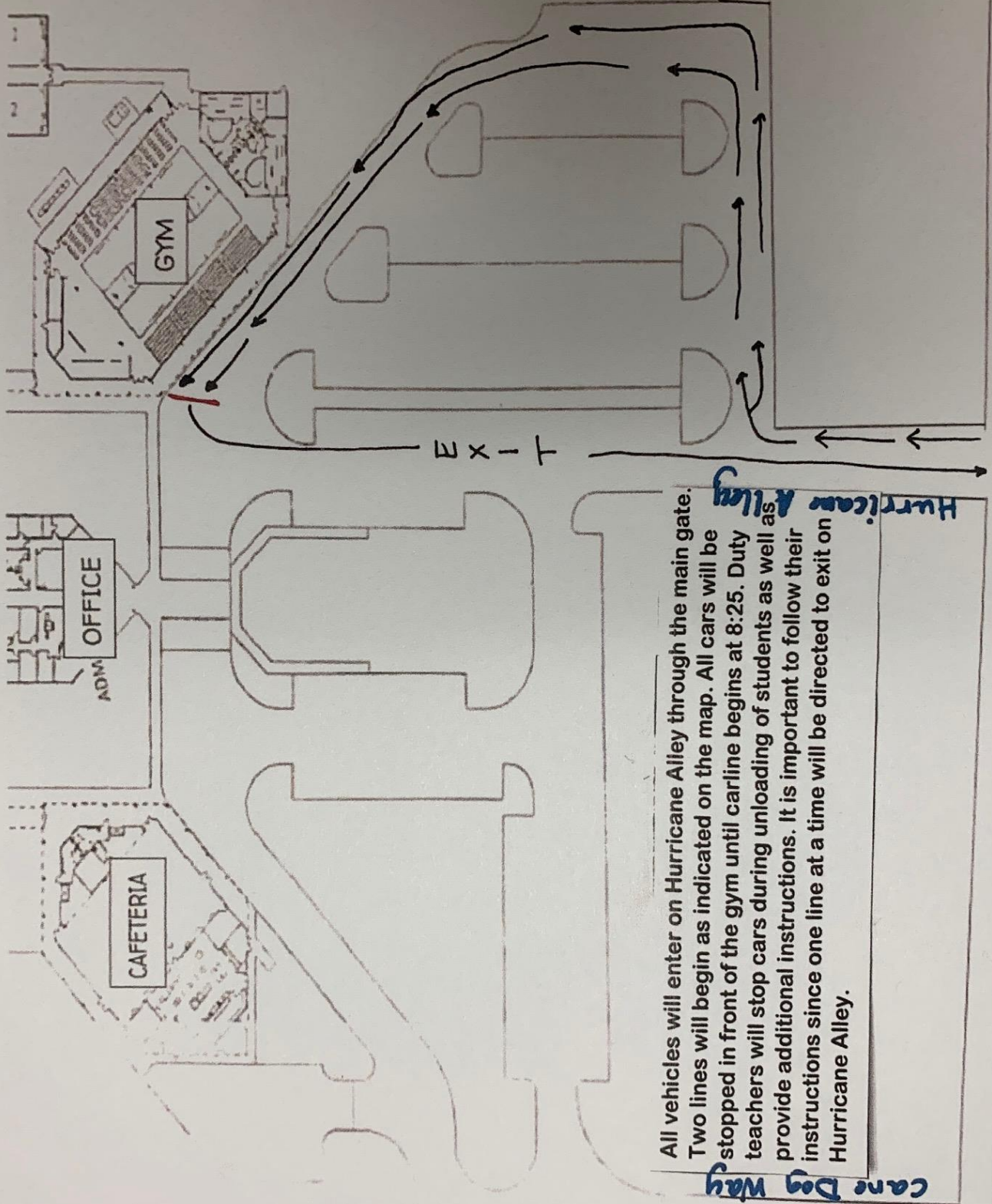

All vehicles will enter on Hurricane Alley through the main gate. Two lines will begin as indicated on the map. All cars will be stopped in front of the gym until carline begins at 8:25. Duty teachers will stop cars during unloading of students as well as provide additional instructions. It is important to follow their instructions since one line at a time will be directed to exit on Hurricane Alley.

Highway 59